

Steel Black 070-080

Technical data

Tapered cylindrical steel pole, prepared for single, double, split-level, triple or quad pole arm installation.
The pole is equipped with an M12 screw, steel inox AISI 304 (grounding).

CONFORMITY



rev. 2020.09

MATERIALS

Core: Steel S355 - hot galvanized | EN 10027 - EN1461
Collar | Top: Die cast aluminium | EN1706

Color: GMR light

TERMINAL BLOCK 4x16mm² Smooth fitting door

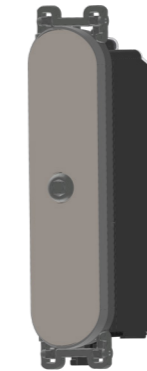

ANCHORAGE TYPE

⊕ Foundation

Supplied: heat-shrink sheath

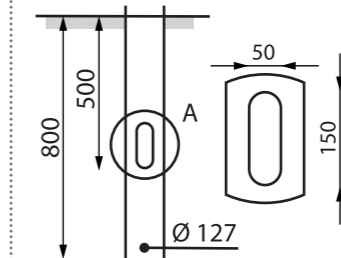

⊕ Flange

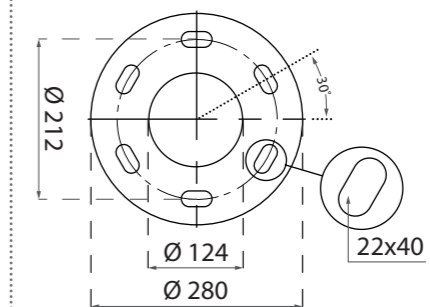

* In case of foundation, the height of the pole is to be understood above the ground.

STEEL BLACK 070

mm 6.900 *

⊕ Flange
SBP070_F
kg 60 Kg

⊕ Foundation
SBP070_M
kg 64 Kg

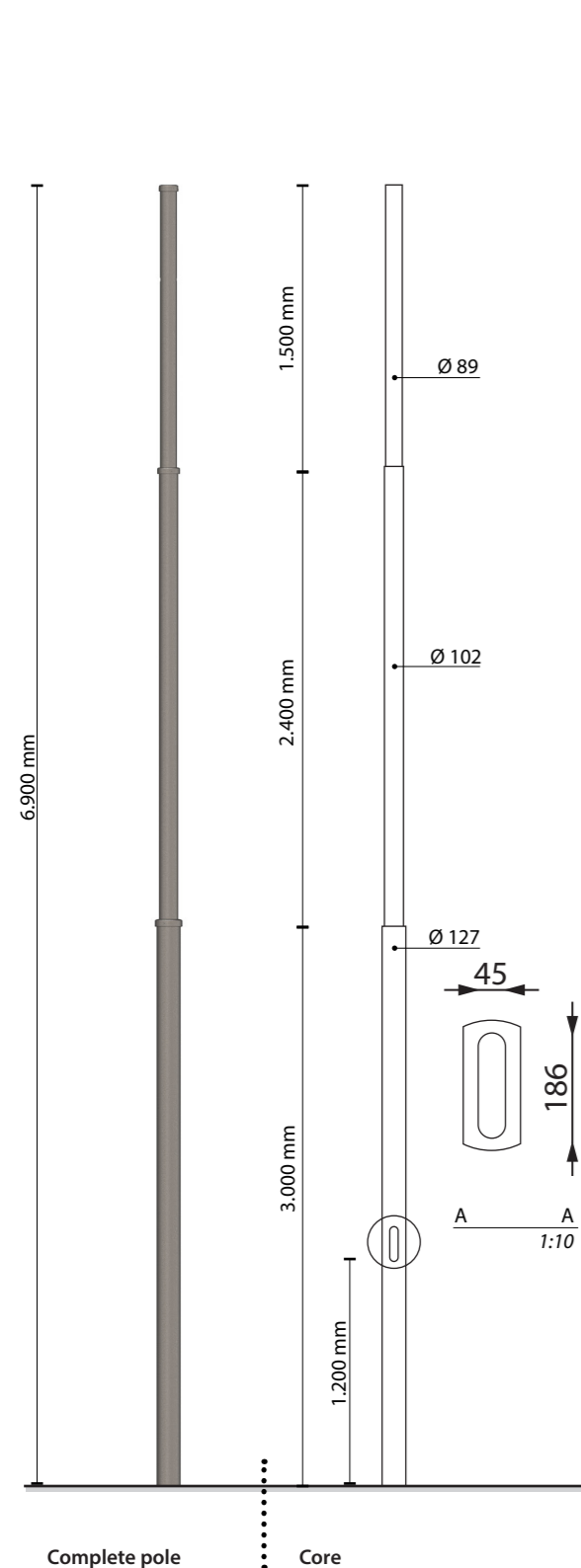

STEEL BLACK 080

mm 7.900 *

⊕ Flange
SBP080_F
kg 69 Kg

⊕ Foundation
SBP080_M
kg 73 Kg

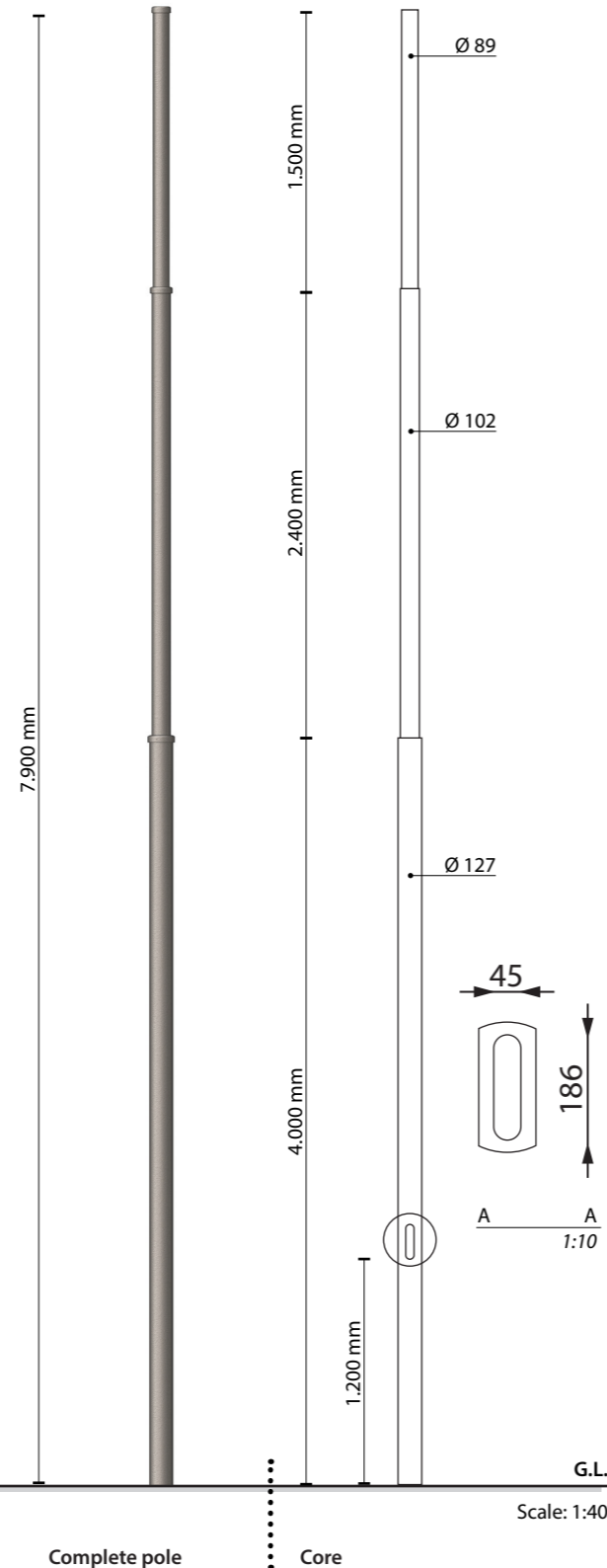

G.L.
Scale: 1:40

Tops

Standard

S

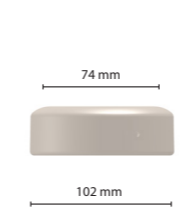

On request

PLD

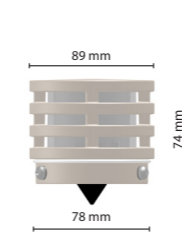

COLLAR

COB

Ø 89 - Ø 102

Ø 102 - Ø 127

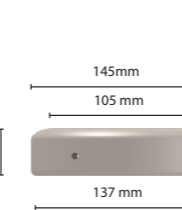
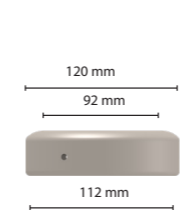

Protection cycles

GMR ENLIGHTS works with cast iron, steel and aluminum. The materials are selected and processed to maximize performance and quality.

GALVANIZED STEEL

Protection of galvanized steel surfaces for poles

The protection of galvanized steel elements is achieved by following steps:

- Micro sandblasting;
- First epoxy layer application followed by: Wilting > Drying > Cooling;
- Acrylic glaze layer application followed by: Wilting > Drying > Cooling;
- Packing at least after 24-hour-drying at room temperature.

Protection of galvanized steel surfaces for brackets and pastorals

The protection of the galvanized steel elements is achieved thanks to:

- Micro sandblasting;
- Phosphoric pickling bath at a ph level ranging from 1.5 to 3;
- Rinsing with demineralised water;
- First powder layer application;
- Kiln firing;
- Application of a final powder layer;
- Kiln roasting of the final powder layer at 180°;
- Cooling.

CAST IRON

Protection of cast iron surfaces for bases

The protection of cast iron elements is achieved by the following treatments:

- Surface micro shotblasting;
- Mono-component dip galvanizing followed by: Wilting > Drying > Cooling;
- Epoxy micaceous primer application followed by: Wilting > Drying > Cooling;
- Acrylic enamel application followed by: Wilting > Drying > Cooling;
- Packing at least after 24-hour-drying at room temperature.

DIE-CAST ALUMINIUM

Protection of die-cast aluminium surfaces for lighting fixtures, tops, collars, brackets and pastorals

Lighting fixtures, brackets, pastoral, and die-cast accessories undergo a cycle of powder painting which creates a barrier against the corrosion of metal parts. Moreover this barrier makes the finished product comply with design specifications in terms of surface roughness, color and reflectance.

The cycle consists of the following steps:

- Micro sandblasting;
- Hot pickling bath in a zinc-based phosphodegreasing solution;
- Specific process for the preparation of surfaces before painting;
- Washing with water;
- Rinsing with demineralised water and subsequent drying;
- First powder layer application followed by kiln baking at 180°;
- Final powder layer application using a High Durability product and final kiln roasting at 180°C.



Salt spray test

The top quality of such treatments is confirmed by salt spray tests performed in accordance with standard ISO 9227:2017 Neutral Salt Spray test (NSS).

The test was carried out for 8.000 hours at 35°C and demonstrated through the report test released.



GMR ENLIGHTS s.r.l.

Legal headquarters:
Strada Provinciale Specchia - Alessano, 68 • 73040 (LE)

Administrative and operational headquarters:
Via Grande n°226 • 47032 Bertinoro (FC)

T +39 0543 462611
F +39 0543 449111

sales@gmrenlights.com
www.gmrenlights.com